

Allegato al bando

 PROVINCIA DI FERRARA U.O.C. PATRIMONIO		data 27/01/16	
oggetto Realizzazione factory creativa		piano terra e 1°	
immobile Ex Comando Prov.le VV.F. via Poledrelli		c.d.c. 680	scala 1: 500
elaborato destinazione spazi		tavola 001	rev. 001
0 _____ 25		FILE 680-003-001	

LEGENDA RETINI

- 
 Spazi non occupati e immediatamente concedibili a nuovi soggetti
- 
 Spazi in uso ad aziende già insediate (art. 4 del bando)
- 
 Spazi in uso alla Provincia (art.4 comma 5 del contratto di comodato)

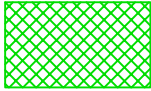
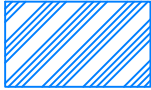
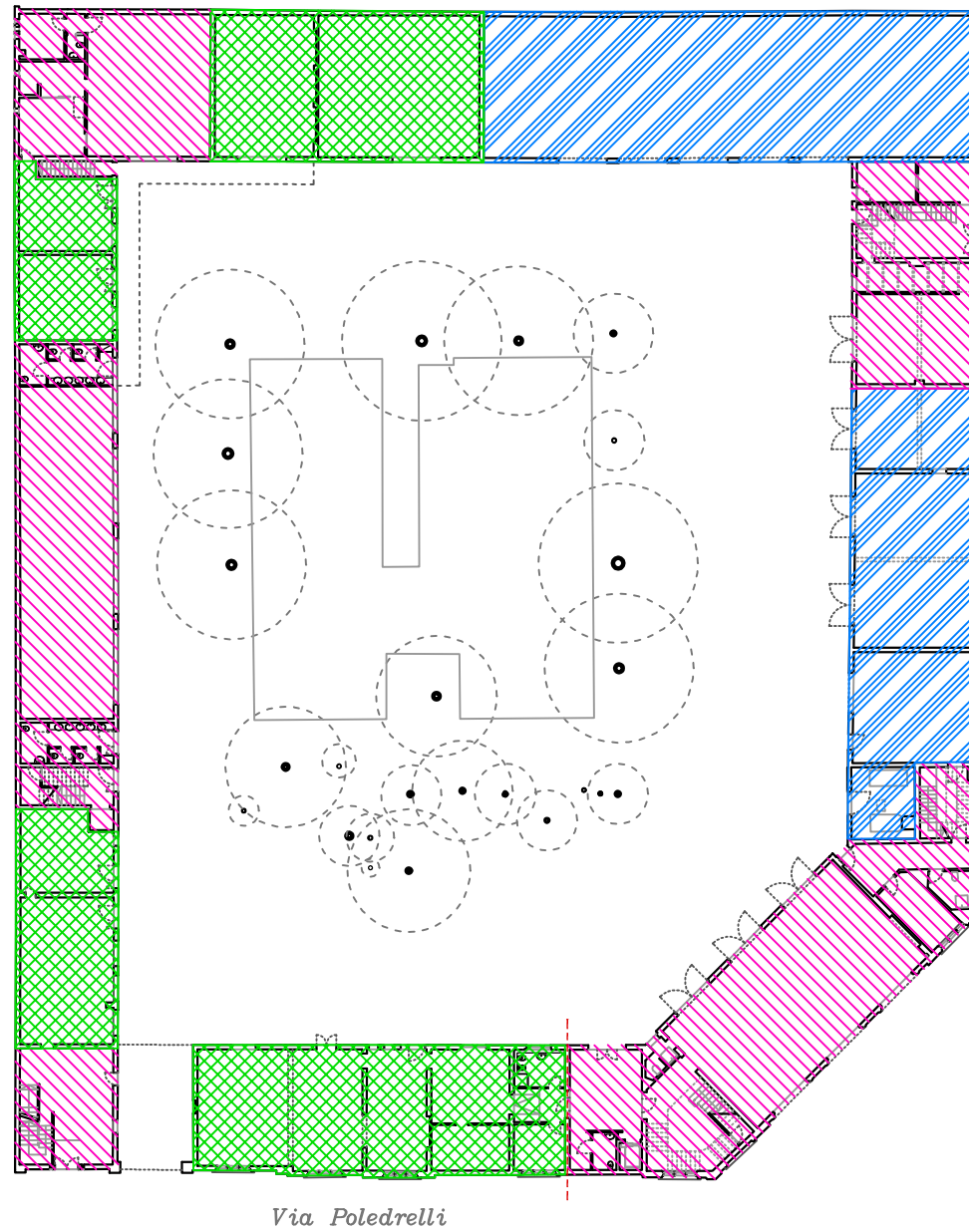

PIANO INTERRATO

PIANO TERRA

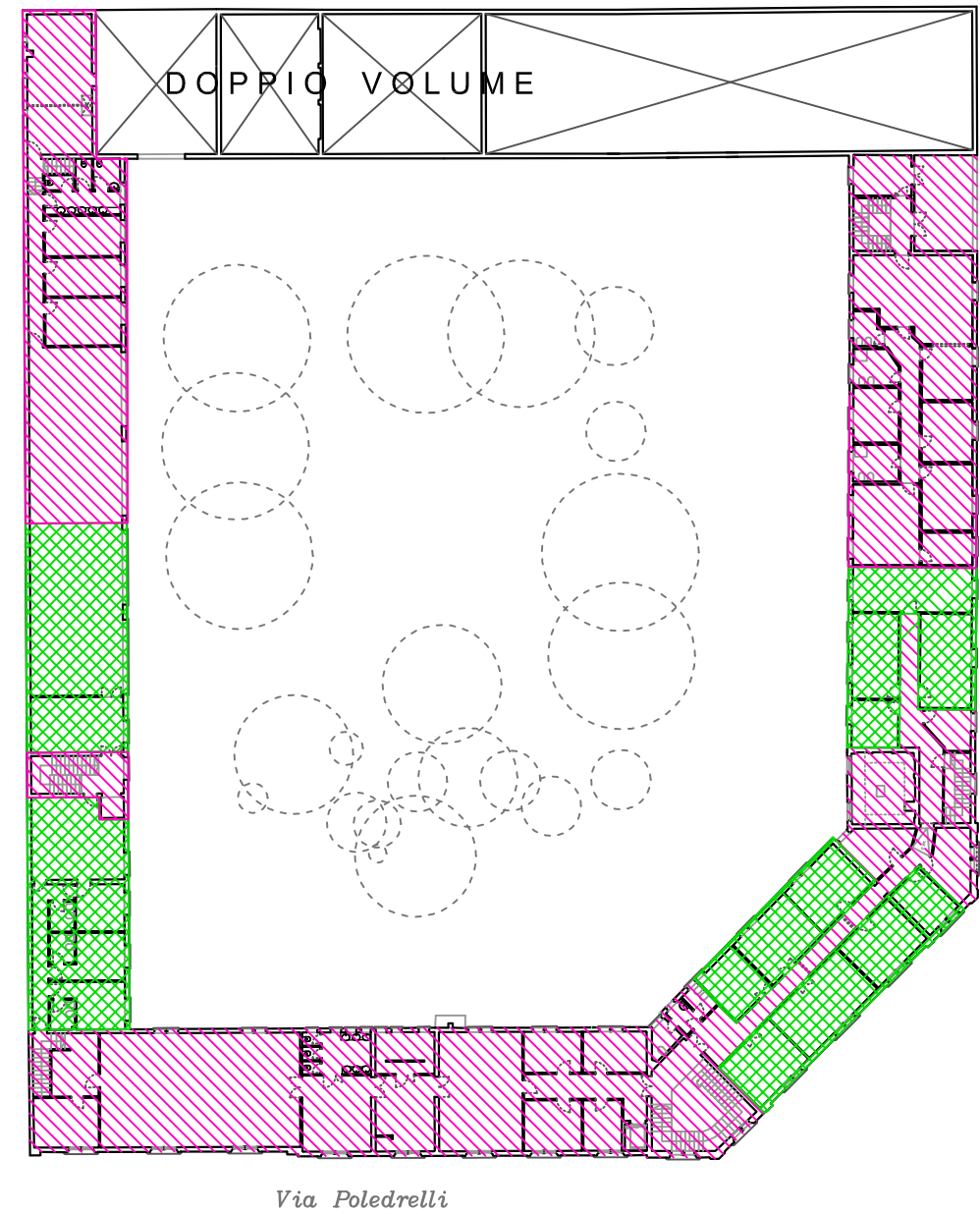

Via Poledrelli

PIANO 1°

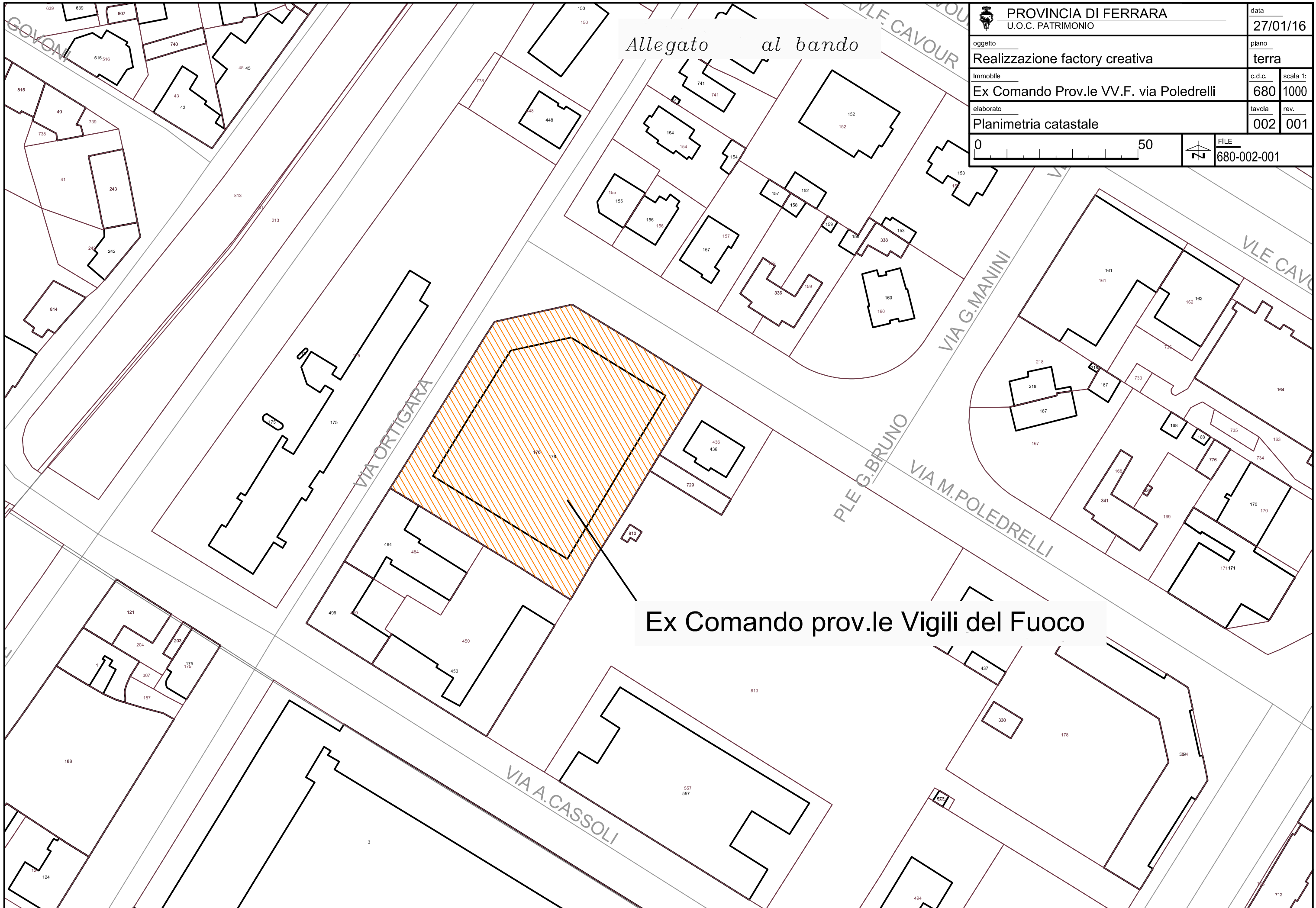

Allegato al bando

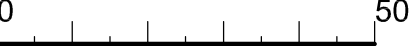
 PROVINCIA DI FERRARA U.O.C. PATRIMONIO		data 27/01/16
oggetto Realizzazione factory creativa	piano terra	
immobile Ex Comando Prov.le VV.F. via Poledrelli	c.d.c. 680	scala 1: 1000
elaborato Planimetria catastale	tavola 002	rev. 001
0  50		FILE 680-002-001

Ex Comando prov.le Vigili del Fuoco

VIA ORTIGARA

VIA G. MANINI

VIA G. BRUNO

VIA M. POLEDRELLI

VIA A. CASSOLI

VLE CAVOUR